

Pressure relief valves type AGAM

two stage, subplate mounting - ISO 6264 size 10, 20 and 32

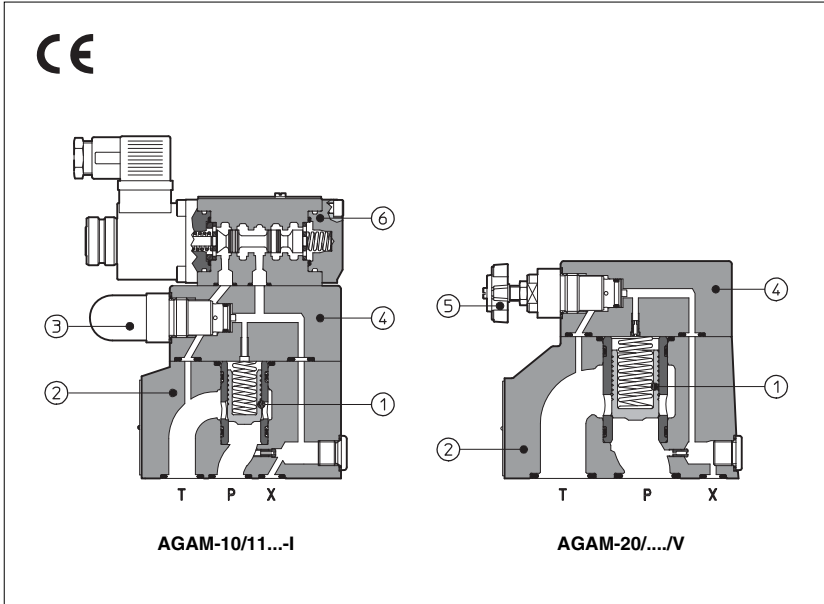

AGAM are double stage pressure relief valves with balanced poppet, designed to operate in oil hydraulic systems.

In standard versions the piloting pressure of the poppet (1) of the main stage (2) is regulated by means of a grub screw (5) in the cover (4). Optional versions with setting adjustment by handwheel (5) instead of the grub screw are available on request. Clockwise rotation increases the pressure.

Also available in safety option with sealed regulation:

- /PED conforming to PED Directive (97/23/CE)

Set pressure at:

AGAM-10 = 25 l/min

AGAM-20 = 25 l/min

AGAM-32 = 25 l/min

For this version the P, Q limits are shown in section 8.

AGAM can be equipped with a solenoid valve (for venting or for different pressure setting).

Mounting surface: ISO 6264 size 10, 20 and 32.

Max flow: 200, 400 and 600 l/min respectively.

Pressure up to 350 bar.

1 MODEL CODE		AGAM	-	20	/	2	0	/210/100/100	/V	/*	-I	X	24DC	**	/*	
						(1)	(1)				(1)	(1)	(1)			
AGAM = pressure relief valve subplate mounting																
Size:		10 20 32														
Number of the different setting pressure values:		1 = one setting pressure 2 = two setting pressure 3 = three setting pressure														
0 = venting with de-energized solenoid																
1 = venting with energized solenoid																
2 = without venting																
Setting: see section 2 for available setting																
Pressure range of second/third setting (not for /PED):		50 = 4÷50 bar; 100 = 6÷100 bar; 210 = 7÷210 bar; 350 = 8÷350 bar														
(1) Only for AGAM with solenoid valve for venting and/or for the selection of the setting pressure																
Options, see section 4		/E /PED /V /WP /Y														
Solenoid of pilot valve:		-I = solenoid OI (DHI) for AC and DC supply														
Only for /PED option		p = required set pressure														
		<div style="border: 1px solid black; padding: 5px; width: fit-content;"> Synthetic fluids: WG = water-glycol PE = phosphate ester Series number </div>														
		Voltage code, see section 6: 00 = solenoid valve without coils (only for OI solenoid)														
		X = without connector See section 5 for available connectors, to be ordered separately														

2 HYDRAULIC CHARACTERISTICS

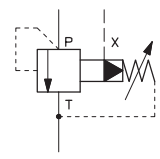
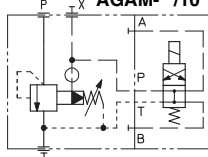
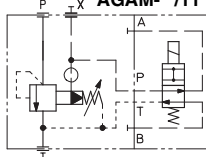
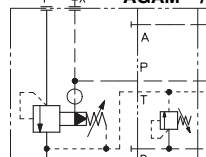
AGAM		AGAM-*/10		AGAM-*/11		AGAM-*/22	
							
		AGAM-*/20		AGAM-*/21		AGAM-*/32	
Valve model		AGAM-10		AGAM-20		AGAM-32	
Setting	standard			50; 100; 210; 350			
	/PED						
Pressure range	standard	4÷50;		6÷100;		7÷210; 8÷350	
	/PED	10÷50;		10÷100;		10÷210; 10÷350	
Max flow	standard	200		400		600	
	/PED						

3 MAIN CHARACTERISTICS OF PRESSURE CONTROL VALVES TYPE AGAM

Assembly position / location	Any position
Subplate surface finishing	Roughness index $\sqrt{0.4}$, flatness ratio 0,01/100 (ISO 1101)
Ambient temperature	-20°C to + 70°C
Fluid	Hydraulic oil as per DIN 51524 . . . 535; for other fluids see section 11
Recommended viscosity	15 ÷ 100 mm ² /s at 40°C (ISO VG 15 ÷ 100)
Fluid contamination class	ISO 19/16, achieved with in line filters at 25 µm value and $\beta_{10} \geq 75$ (recommended)
Fluid temperature	-20°C +60°C (standard and /WG seals) -20°C +80°C (/PE seals)

3.1 Coils characteristics

Insulation class	H
Connector protection degree	IP 65
Relative duty factor	100%
Supply voltage and frequency	See electric feature 7
Supply voltage tolerance	± 10%

4 OPTIONS

/E = external pilot

/PED = conforming to Directive 97/23/CE (not available with option *V*)

/V = regulating handwheel instead of grub screw protected by cap (for handwheel features, see table K150), (not available with option /PED)

/MP = prolonged manual override protected by rubber cap (only for AGAM with pilot solenoid valve)

/Y = external drain (only for AGAM with pilot solenoid valve)

5 ELECTRIC CONNECTORS ACCORDING TO DIN 43650 FOR AGAM WITH SOLENOID VALVE

The connectors must be ordered separately

Code of connector	Function
SP-666	Connector IP-65, suitable for direct connection to electric supply source
SP-667	As SP-666 connector IP-65 but with built-in signal led, suitable for direct connection to electric supply source

For other available connectors, see tab. E010 and K500.

6 ELECTRIC FEATURES FOR AGAM WITH SOLENOID VALVE

Type of solenoid	External supply nominal voltage ± 10% (1)		Voltage code	Type of connector	Power consumption (3)	Code of spare coil	Colour of coil label
OI	DC	6 DC	6 DC 12 DC 24 DC 48 DC	SP-666 or SP-667	33 W	SP-COU-6DC /80 SP-COU-12DC /80 SP-COU-24DC /80 SP-COU-48DC /80	brown green red silver
		12 DC					
24 DC							
48 DC							
AC	110/50 AC (2) 120/60 AC 230/50 AC (2) 230/60 AC	110/50/60 AC	110/50/60 AC 120/60 AC 230/50/60 AC 230/60 AC	SP-666 or SP-667	60 VA (4)	SP-COI-110/50/60AC /80 SP-COI-120/60AC /80 SP-COI-230/50/60AC /80 SP-COI-230/60AC /80	yellow white light blue silver
		120/60 AC					
		230/50/60 AC					
		230/60 AC					

(1) For other supply voltages available on request see technical table E010.

(2) Coil can be supplied also with 60 Hz of voltage frequency: in this case the performances are reduced by 10 ÷ 15% and the power consumption is 55 VA.

(3) Average values based on tests performed at nominal hydraulic condition and ambient/coil temperature of 20°C.

(4) When solenoid is energized, the inrush current is approx 3 times the holding current. Inrush current values correspond to a power consumption of about 150 VA.

7 REGULATED PRESSURE VERSUS FLOW DIAGRAMS based on mineral oil ISO VG 46 at 50°C

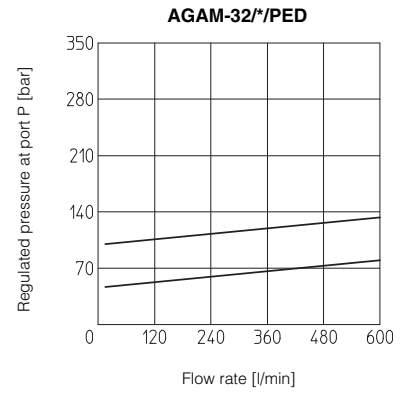
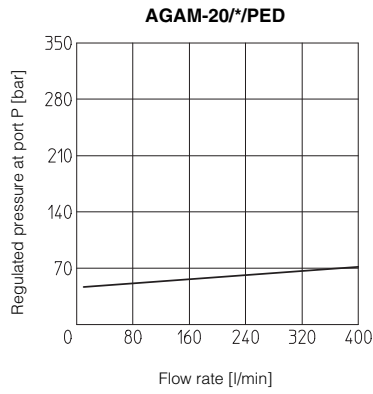
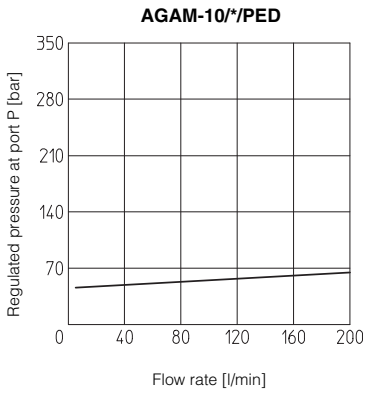
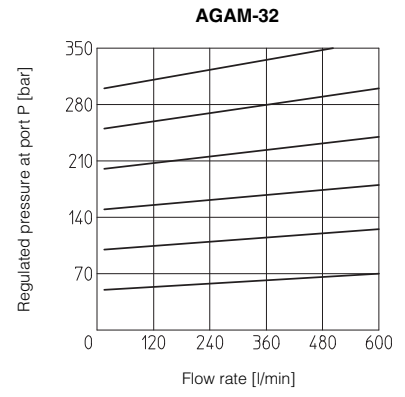
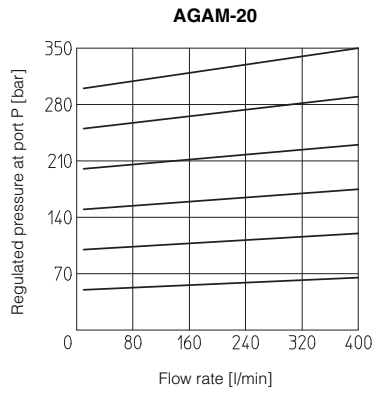
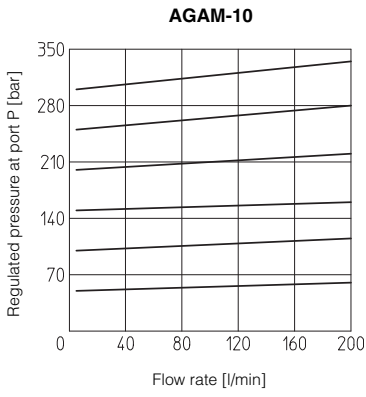

8 PERMISSIBLE RANGE (shared area) based on mineral oil ISO VG 46 at 50°C

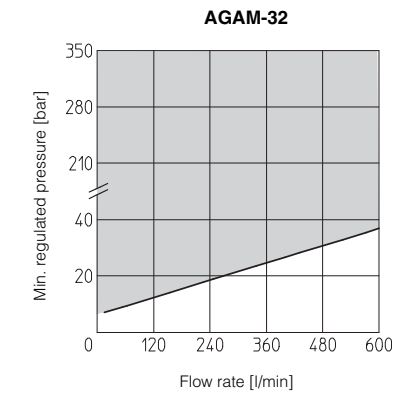
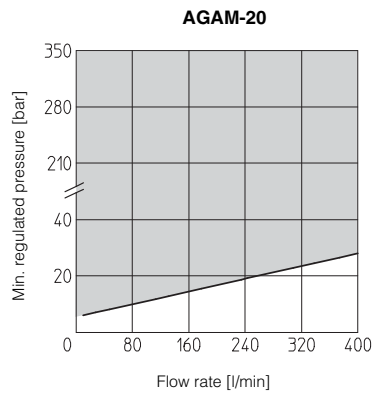
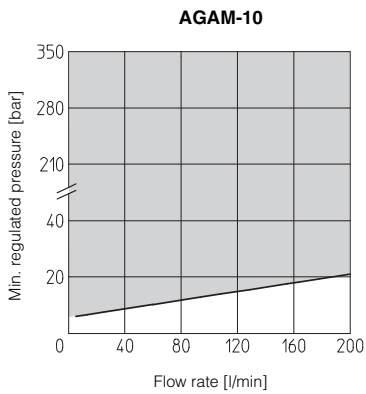

9 MINIMUM PRESSURE VERSUS FLOW DIAGRAMS based on mineral oil ISO VG 46 at 50°C

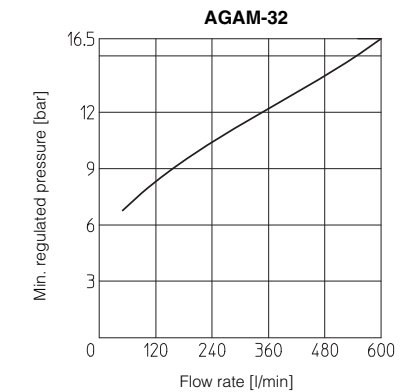
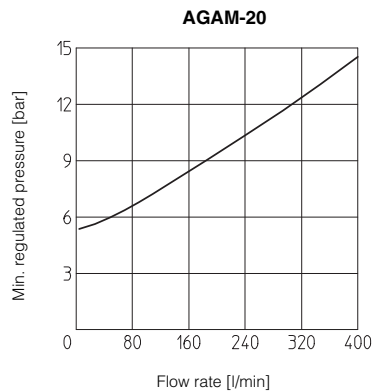
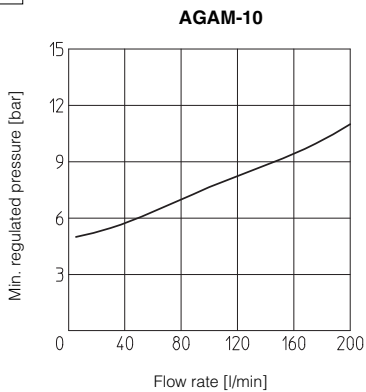

AGAM-10

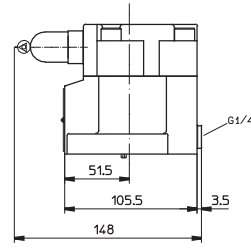
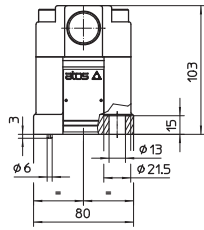
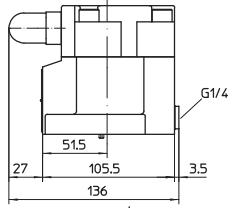

Mass: 3,6 Kg

OPTION / PED

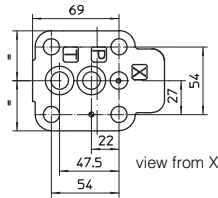

ISO 6264: 2007
Mounting surface: 6264-06-09-1-97
 Fastening bolts:
 4 socket head screws M12x35 class 12.9
 Tightening torque = 125 Nm
 Seals: 2 OR 123; 1 OR 109/70
 Ports P, T: Ø = 14,5 mm
 Ports X: Ø = 3,2 mm

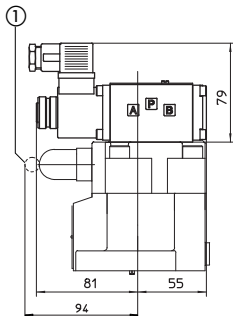

AGAM-10/10-IX**
AGAM-10/11-IX**
 Mass: 5,1 Kg

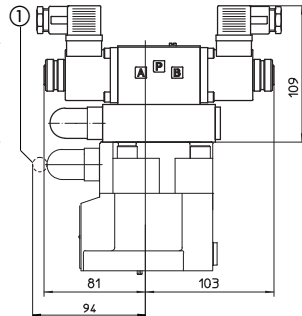

AGAM-10/20-IX**
AGAM-10/21-IX**
 Mass: 6,2 Kg

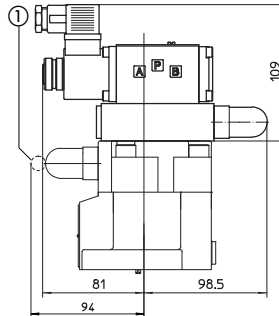

AGAM-10/22-IX**
 Mass: 5,9 Kg

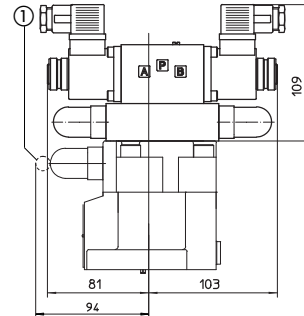

AGAM-10/32-IX**
 Mass: 6,3 Kg

① = sealed adjustment only for /PED option

AGAM-20

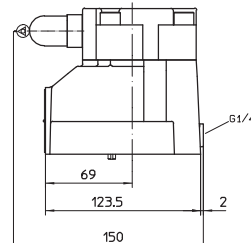
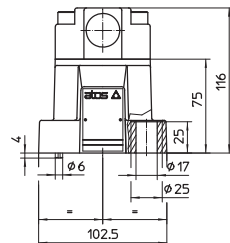
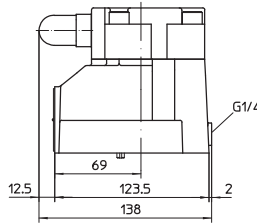

Mass: 4,8Kg

OPTION / PED

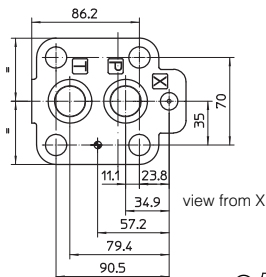

ISO 6264: 2007
Mounting surface: 6264-08-11-1-97
 Fastening bolts:
 4 socket head screws M16x50 class 12.9
 Tightening torque = 300 Nm
 Seals: 2 OR 4112; 1 OR 109/70
 Ports P, T: Ø = 24 mm
 Ports X: Ø = 3,2 mm

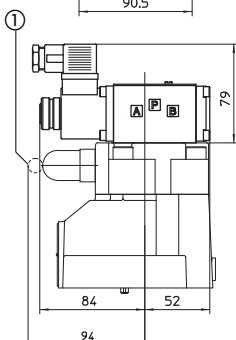

AGAM-20/10-IX**
AGAM-20/11-IX**
 Mass: 6,3 Kg

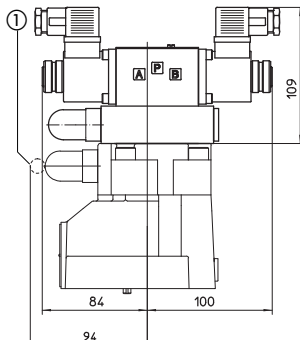

AGAM-20/20-IX**
AGAM-20/21-IX**
 Mass: 7,4Kg

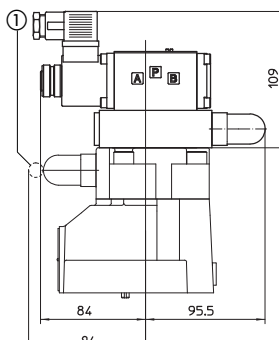

AGAM-20/22-IX**
 Mass: 7,1 Kg

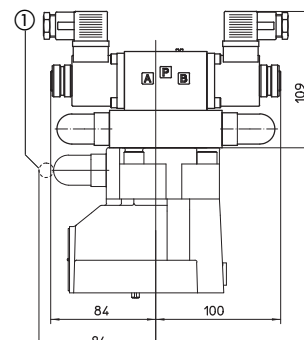

AGAM-20/32-IX**
 Mass: 7,5 Kg

① = sealed adjustment only for /PED option

8 DIMENSIONS [mm]

AGAM-32

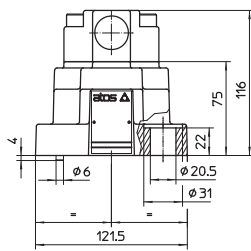
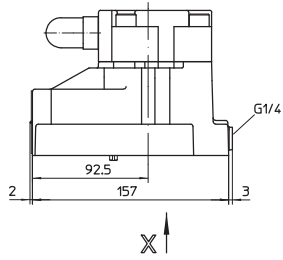

Mass: 6,2 Kg

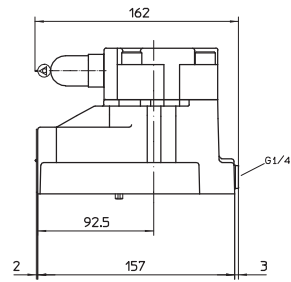

OPTION /PED

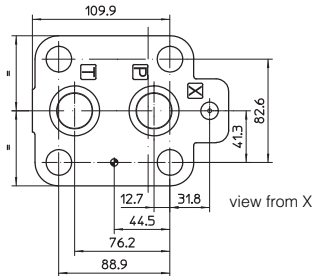

ISO 6264: 2007
Mounting surface: 6264-10-17-1-97
(with M20 fixing holes instead of standard M18)

Fastening bolts:
4 socket head screws M20x60 class 12.9
Tightening torque = 600 Nm
Seals: 2 OR 4131; 1 OR 109/70
Ports P, T: Ø = 28,5 mm
Ports X: Ø = 3,2 mm

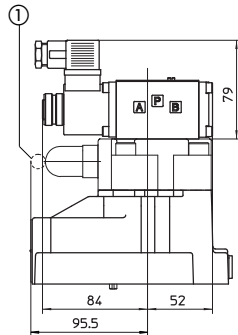

AGAM-32/10/**-IX
AGAM-32/11/**-IX

Mass: 7,7 Kg

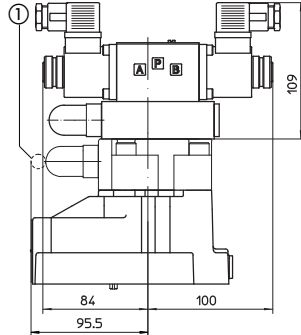

AGAM-32/20/**-IX
AGAM-32/21/**-IX

Mass: 8,8 Kg

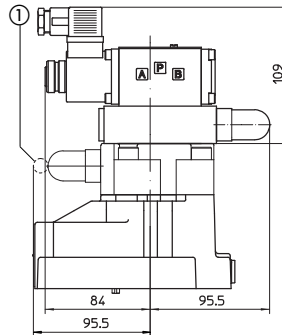

AGAM-32/22/**-IX

Mass: 8,5 Kg

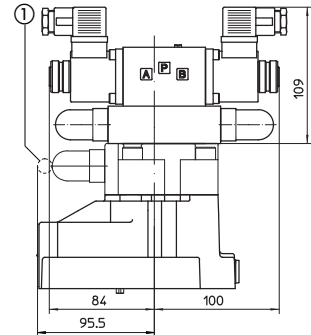

AGAM-32/32/**-IX

Mass: 8,9 Kg

① = sealed adjustment only for /PED option

Overall dimensions refer to valves with connectors type SP-666

9 MOUNTING SUBPLATES

Valve	Subplate model	Port location	Ports			Ø Counterbore [mm]			Mass [Kg]
			P	T	X	P	T	X	
AGAM-10	BA-306	Ports P, T, X underneath;	G 1/2"	G 3/4"	G 1/4"	30	36,5	21,5	1,5
AGAM-20	BA-406		G 3/4"	G 3/4"	G 1/4"	36,5	36,5	21,5	3,5
	BA-506		G 1"	G 1"	G 1/4"	46	46	21,5	3,5
AGAM-32	BA-706		G 1 1/2"	G 1 1/2"	G 1/4"	63,5	63,5	21,5	6

The subplates are supplied with fastening bolts. For further details see table K280